



**RECORD OF TITLE
UNDER LAND TRANSFER ACT 2017
CROSS LEASE**



**Guaranteed Search Copy issued under Section 60 of the Land
Transfer Act 2017**

R.W. Muir
Registrar-General
of Land

Identifier SA28A/1498
Land Registration District South Auckland
Date Issued 27 July 1982

Prior References
SA8C/126

Estate Fee Simple - 1/2 share
Area 839 square metres more or less
Legal Description Lot 8 Deposited Plan South Auckland
11891

Registered Owners
Beth Patsy Parish

Estate	Leasehold	Instrument	L H421717.2
Legal Description	Flat 2 Deposited Plan South Auckland 32091	Term	999 years commencing on 1.7.1982

Registered Owners
Beth Patsy Parish

Interests

- S388907 Building Line Restriction (affects Arapuni Street) (Affects Fee Simple)
- H421717.1 Lease of Flat 1 and Carport 1 DPS 32091 Term 999 years commencing on 1.7.1982 Composite CT SA28A/1497 issued - 27.7.1982 at 1.40 pm (Affects Fee Simple)
- H421717.2 Lease of Flat 2 DPS 32091 Term 999 years commencing on 1.7.1982 Composite CT SA28A/1498 issued - 27.7.1982 at 1.40 pm (Affects Fee Simple)
- B483674.2 Mortgage to ANZ Banking Group (New Zealand) Limited - 27.5.1998 at 1.46 pm
- 6004131.2 Surrender of Lease H421717.2 as to Carport 2 DPS 32091 - 14.5.2004 at 9:00 am
- 6004131.3 Variation of Lease H421717.1 - 14.5.2004 at 9:00 am
- 6004131.4 Variation of Lease H421717.2 - 14.5.2004 at 9:00 am

Putaruru Borough

i
S
O
H
H
E
C
E

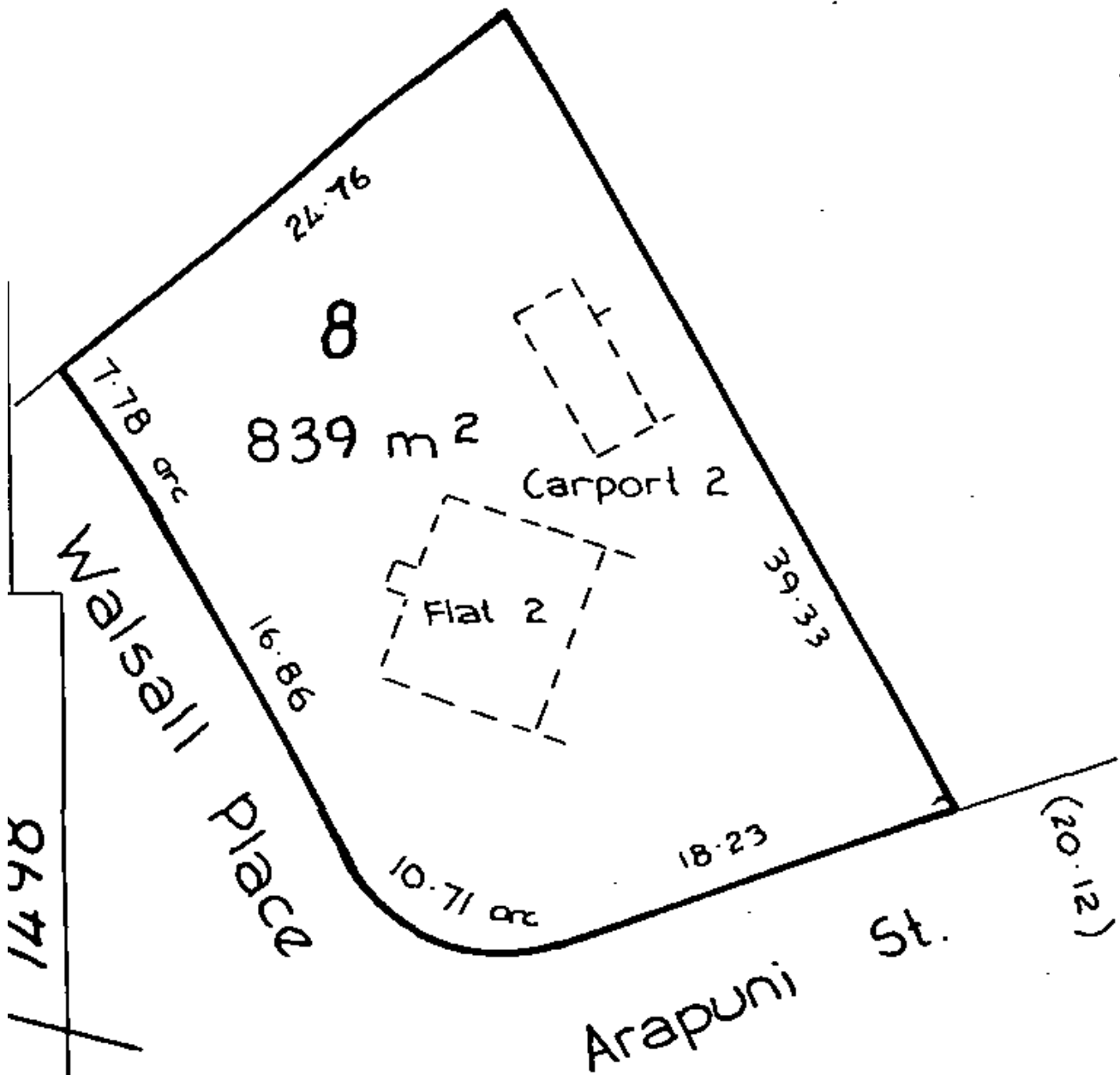

28 A / 1498

Measurements are Metric