

BARBADOS

159m²
 3
 2
 2
 1

The smooth internal flow of the Barbados plan makes this traditional home a popular choice.

HOME FEATURES

- Three bedrooms with ensuite and walk-in wardrobe to large master bedroom
- Open plan kitchen, dining and living areas
- Double garage with laundry
- 10 year Residential Builders Guarantee



HOME DIMENSIONS

Length: 17.6m

Width: 13.1m

Area over brick: 159.11m²

Area over framing: 151.06m²



NIKAU

158m² 3 2 2 1

The Nikau is a modern three bedroom home with a great open-plan living, kitchen and dining area.

HOME FEATURES

- Three bedroom home
- Separate master bedroom with ensuite and walk-in wardrobe
- Open-plan kitchen, dining and family areas
- Double garage with internal access and laundry
- Fixed-price contract
- Guaranteed move-in day
- 10 year Residential Builders Guarantee

HOME DIMENSIONS

Length: 17.0m

Width: 12.3m

Area over brick: 158.81m²

Area over framing: 151.52m²



KAITUNA

200m²
 4
 2
 2
 2

Featuring great indoor/outdoor flow and a spacious two car garage, the Kaituna is big enough for all your toys. It also boasts open-plan living space with a separate formal lounge – perfect for all the family.

HOME FEATURES

- Four bedroom with ensuite and walk-in wardrobe to master bedroom
- Open-plan kitchen, dining and family area
- Scullery
- Separate lounge
- Double garage with internal access and laundry
- Fixed-price contract
- Guaranteed move-in date
- 10-year Residential Build guarantee

HOME DIMENSIONS

Length: 19.68m

Width: 13.08m

Area over brick: 200.21m²

Area over framing: 193.16m²



GENEVA

181m² 3 2 2 2

The open plan kitchen and dining area with its central island bench definitely makes this space the hub of the home. With three bedrooms and two bathrooms, the Geneva plan is a spacious home with ample storage and extra features.

HOME FEATURES

- Galley kitchen with island
- Three bedrooms including master with ensuite and walk-in wardrobe
- Large family bathroom with both shower and bath
- Double garage with internal access with laundry and storage
- Fixed-price contract
- Guaranteed move-in day
- 10 year Residential Builders Guarantee

HOME DIMENSIONS

Length: 20.1m

Width: 11.9m

Area over brick: 173.5m²

Area over framing: 181.6m²

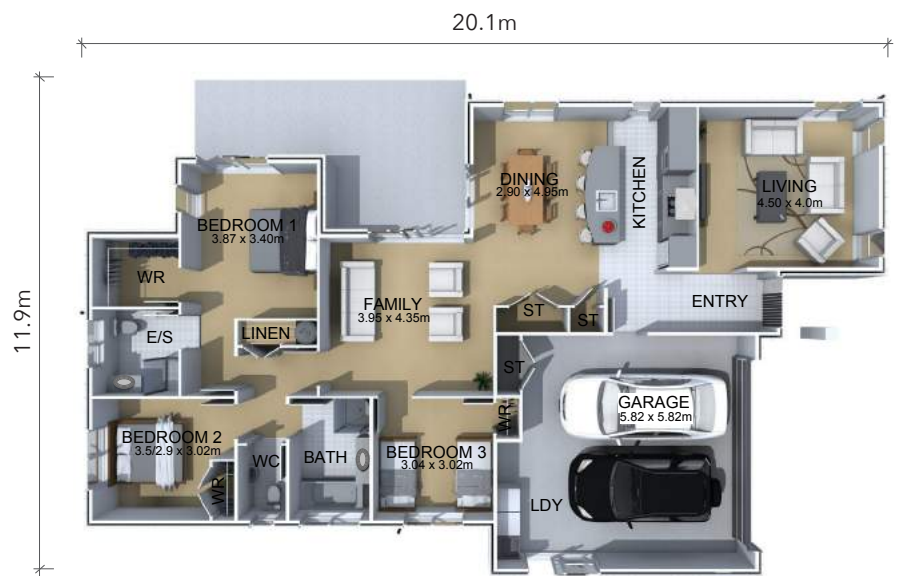

**VIEW THIS PLAN AS A
GENERATION SHOWHOME**

20 Kowi Lakes Drive, One Tree Point,
Whangarei